

south cambridgeshire

Client: Development Securities /
South Cambridgeshire District Council

district council hq

AukettFitzroyRobinson worked closely with SCDC and their project manager agents Lambert Smith Hampton, to create a new workplace strategy for the Council.

Our concept created naturally-ventilated, open plan offices on 15m floorplates, set around a open street that acts as a stack to further encourage the ventilation strategy. Limited cellular space is located at the ends of the plates and specialist areas are concentrated in the west wing at ground and first floor.

SCDC had a clearly defined programme which necessitated a demanding design and construction programme. The building also had to achieve a BREEAM 'Excellent' rating and contractually-binding internal climate conditions. The agreement to lease incorporated specific 'drop-dead' milestones including foundation completion, frame, weathertight and final fitout completion. These milestones set agreed payments between the developer and SCDC.

Our initial design input proposed a 'low energy' sustainable concept and an internal environment to encourage open communication and a welcoming environment for visitors and public users of the building.

We worked closely with the client's agents to develop the base build design, incorporating the specific requirements of the general office environment and access for the public and visitors. A clear distinction was made to define the base build and user enhancements together with CAT B fit out.



The building achieved a BREEAM 'Excellent' rating and was winner of a Regional BCO Award for Best Corporate Workplace

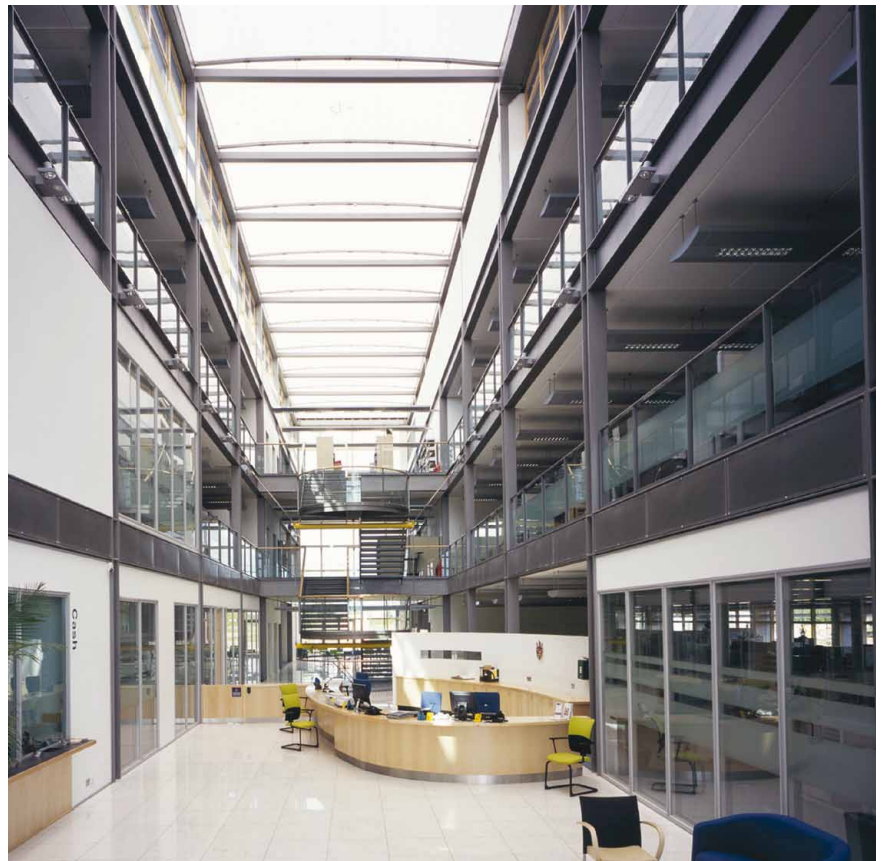

Aukett Fitzroy Robinson